

EJOT Super-SAPHIR® Self-Drilling JT6-FR6 Range



Ultimate Fastener Tensile Strength



Fastener Dia	kN
5.5 x L	11.50

Ultimate Fastener Shear Strength

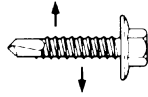

Fastener Dia	kN
5.5 x L	7.50

Ultimate Pullout Load kN

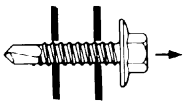

Figures based on tests from steel designated as Grade Z35 (BS 2989)

Fastener Dia	Nominal Steel Thickness (mm)							
	1.20	1.50	2.00	2.50	3.00	4.00	5.00	6.00
5.5 x L	2.2	2.38	3.65	4.28	5.71	8.59	11.50*	11.50*

Figures based on use with R38 profile steel sheets with fastener located in

Figures above are based on results obtained from tests carried out in our Applitec lab in accordance with equipment conforming to BS 5427 on a random sample of fasteners manufactured to EJOT tolerances. Information supplied should form part of a general guide and should performance data for

Material Specification

Fastener.
High quality Stainless steel grade 316 St/St, ISO group A4, Din Werkstoff 1.4401.

Drill Point
High quality grade casehardened carbon steel to DIN standard 10666.

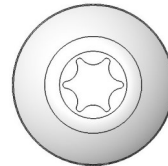

TORX®
T25
Recess