

EJOT Super-SAPHIR® Self-Drilling JT4-FR-2-4.9 Range

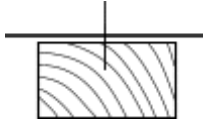

Material Specification

High quality Stainless steel grade 304 St/St, ISO group A2, Din Werkstoff 1.4301.

Drive System

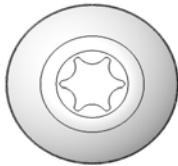

TORX®
T25
Recess

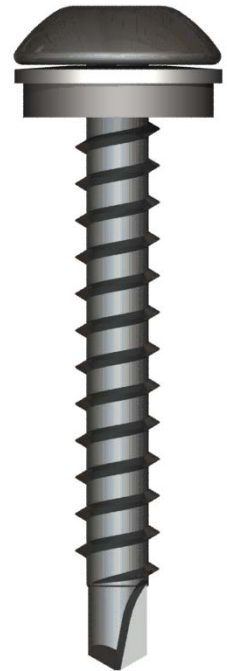

Mechanical Performance

Ultimate Fastener Shear Strength

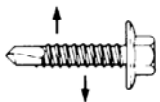

Fastener Dia	kN
4.9 x L	5.10

Ultimate Fastener Tensile Strength



Fastener Dia	kN
4.9 x L	8.05

Ultimate Pullout Load kN

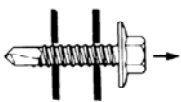

Fastener Dia	Timber		Plywood	
	25mm Embedment	30mm Embedment	12mm Thick	18mm Thick
4.9 x L	2.011	2.830	1.357	2.491

Figures based on tests from timber designated GS Graded (SC3) to BS 5268 Pt. 2 1984.
All plywood construction grade.

Figures above are based on results obtained from tests carried out in our Applitec lab in accordance with equipment conforming to BS 5427 on a random sample of fasteners manufactured to EJOT tolerances. Information supplied should form part of a general guide and should performance data for a specific application be required please do not hesitate to contact us.

EJOT UK Limited Sherburn-in-Elmet, Leeds LS25 6PB.
Tel: 01977 687040 Fax: 01977 687041
www.ejot.co.uk info@ejot.co.uk

EJOT The Quality
Connection