

Insulation support DHK

OVERVIEW

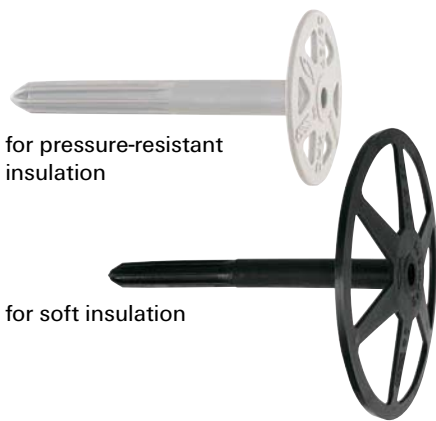

for pressure-resistant insulation

for soft insulation

Insulation support **DHK 45**, plate- \varnothing 45 mm

Insulation support **DHK**, plate- \varnothing 90 mm

Suitable for:

- Concrete
- Natural stone with dense structure
- Solid brick
- Solid sand-lime brick
- Solid block made from lightweight concrete
- Aircrete
- Vertical perforated brick
- Perforated sand-lime brick



For fixing of:

Soft and pressure-resistant insulating material, e.g.

- Glass wool
- Rock wool
- Polystyrene
- PU panels
- Foam glass
- Light building boards made of wood wool
- Coir matting
- Cork boards

DESCRIPTION

- Impact-resistant plastic insulation fixing.
- When driven in, the fixing grips the hole walls by means of its ring profile.

Advantages/benefits

- Small min. anchoring depth reduces the amount of drilling.
- Simple and quick hammer-set installation saves work.

- Flexible ribs in the disc for continuous pressure of the thermal insulation.
- No buckling of the shank.
- No additional screws or nails.
- Different plate sizes for various applications.
- Due to black colouring the DHK does not stand out on clad insulating material.

INSTALLATION

Type of installation

- Push-through installation

Installation tips

- Temperature range when installed: - 40° C to + 80° C

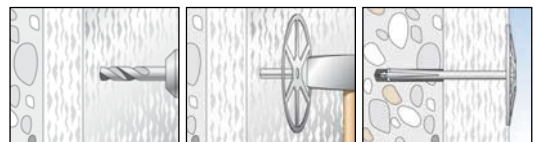

TECHNICAL DATA

Type	Art.No.	drill- \varnothing		min. drill-hole depth t_d [mm]	effect. anchorage depth h_{ef} [mm]	anchor length l [mm]	max. usable length		qty. per box pcs.
		d_0 [mm]	t_d [mm]				t_{fix} [mm]		
DHK 40	080937	8	35	20	65	40	250		
DHK 60	080938	8	35	20	85	60	250		
DHK 80	080939	8	35	20	105	80	250		
DHK 100	080940	8	35	20	125	100	250		
DHK 120	080941	8	35	20	145	120	200		
DHK 140	080949	8	35	20	165	140	200		
DHK 45/40	080892	8	35	20	65	40	250		
DHK 45/60	080893	8	35	20	85	60	250		
DHK 45/80	080894	8	35	20	105	80	250		
DHK 45/100	080895	8	35	20	125	100	250		

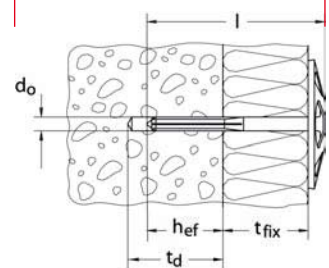

LOADS

Recommended loads N_{rec} and mean ultimate loads N_u [kN].

Substrate	N_u	N_{rec}
Concrete \geq C12/15	0.24	0.03
Solid brick Mz 12	0.22	0.03
Solid sand-lime brick KSV 12	0.24	0.03
Perforated sand-lime brick KSL 6	0.20	0.03
Vertical perforated brick HLz 12	0.12	0.02
Aircrete G2	0.13	0.02